

## 4B WIRE YOUR NEW DIMMER

**3-Way Circuit:**  
Connect the GREEN OR BARE dimmer ground wire to the green or bare copper ground wire in the wall-box.

Connect the BLACK dimmer wire to the tag wire removed from the switch.

Connect the RED dimmer wires to the remaining wires removed from the switch.

**IMPORTANT:**  
In a 3-WAY circuit, only one dimmer can be used.

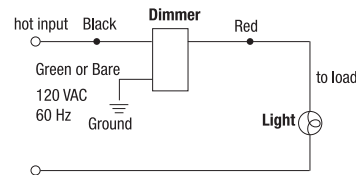
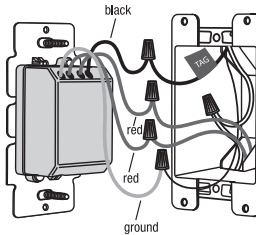

## 5 SEPARATE MOUNTING FRAME FROM WALL PLATE

Gently insert screwdriver into slots to separate mounting frame from wall plate.

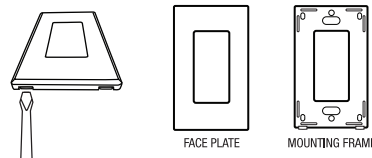

## 6 INSERT DIMMER INSIDE THE WALL-BOX

Carefully position all wires inside the wall-box, leaving enough room to insert the dimmer housing.

Mount the dimmer securely inside the wall-box using the provided mounting screws.

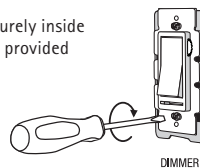

## 7 TURN POWER ON

Turn power on at circuit breaker or replace the fuse. Try out your new dimmer.

If you're satisfied with dimming range and light output of your bulbs, *proceed to step 8.*

**NOTE:** Most dimmable LEDs may not dim as low as incandescent or halogen bulbs. Dimming range of dimmable LEDs can vary from manufacturer to manufacturer. This dimmer has an adjustable dimming range. If your bulbs hum, buzz or flicker see below for dimmer adjustment.

### ADJUSTING DIMMING RANGE:

The dimmer can be adjusted to eliminate lamp flicker at the low end of the dimming range by following these steps:

1. Turn dimmer on and move slider all the way to the left.
2. Turn adjustment wheel down (clockwise).
3. Turn adjustment wheel up (counter-clockwise) to achieve lowest light level so that light output is stable for all bulbs. Set your slider to where there's no hum or flickering on all bulbs.
4. Turn dimmer off- then back on to make sure bulbs turn on.
5. If all bulbs do not turn on, turn adjustment wheel up slightly (counter-clockwise) and repeat step 3.
6. Once all bulbs are properly dimming, install face plate.

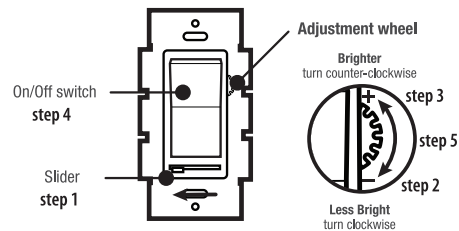

## 8 INSTALL MOUNTING FRAME

Place the mounting frame over your installed dimmer and secure it using provided screws.

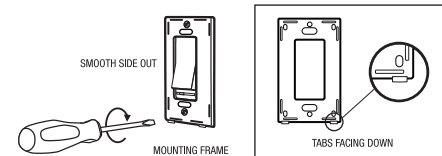

## 9 INSTALL THE WALL PLATE

Place the decorative wall plate over the installed mounting frame with the top first then the bottom. Gently push wall plate to ensure flush fit.

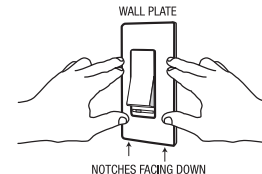

## 10 INSTALLATION COMPLETE

Bright33® is a subsidiary of  
Stream33 Products LLC  
350 Courtney Road, Sebring, Ohio 44672 USA

Rev. 180425



Thank you for purchasing Bright33® LED Dimmer Switches.

## INSTALLATION INSTRUCTIONS MODEL: B33UNILEDIM

### Bright33® LED Dimmer Switch With Cover

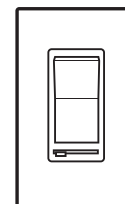

Toll Free: 1-800-316-2532

www.bright33.com

Bright33® is a subsidiary of  
Stream33 Products LLC  
350 Courtney Road, Sebring, Ohio 44672 USA

© 2018 Stream33 Products LLC. All rights reserved.

## PLEASE READ CAREFULLY BEFORE INSTALLATION

Save these instructions, as you may need them at a later date.

Turn power off before installation, inspection, or removal. Use all necessary precautions while performing this procedure.

Consult a qualified electrician to ensure correct branch circuit conductor. Min 90°C supply conductors.

Properly ground electrical enclosure. IT IS IMPERATIVE THAT THE OUTLET BOX BE PROPERLY GROUNDED.

DO NOT REVERSE THE HOT AND NEUTRAL CONNECTIONS, OTHERWISE SAFETY WILL BE COMPROMISED.

### WARNING:

This product may represent a possible shock or fire hazard if improperly installed or attached in any way. Product should be installed in accordance with the owners manual, current electrical codes and/or the current National Electric Code (NEC).



### RISK OF FIRE

- DO NOT USE WITH CONTROL RECEPTACLE OUTLETS, FLUORESCENT LIGHTING FIXTURES, MOTOR-OPERATED APPLIANCES OR TRANSFORMER SUPPLIED APPLIANCES
- DO NOT EXCEED ELECTRICAL RATINGS
- USE ONLY COPPER WIRES WITH THIS DEVICE
- USE INDOORS ONLY

## MULTI-GANG INSTALLATION

If installing multiple dimmers in the same box, you may need to remove the inside tabs on the dimmers before continuing with the wiring installation (see illustration). [You may also need to purchase multi-gang cover plates (not included)]. If there is a previous dimmer in the switch box, be sure to turn the power OFF at the circuit breaker or fuse box and then remove the wall-plate. To avoid damage to the dimmer, use a tool such as pliers to grasp the tabs, and move back and forth until they snap off at the break line. Only do this for each row of tabs that need removal so the dimmers will fit side by side in the switch box.

120 Volt • 60Hz  
600 Watt MAX incandescent  
150 Watt MAX dimmable LED

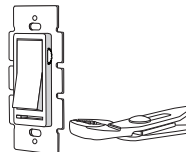

### Do NOT Remove Outside Tabs

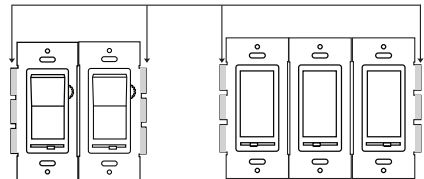

Both dimmers have inside tabs removed.

Inside dimmer has both side tabs removed while outside dimmers have only the inside tabs removed.

## IMPORTANT WIRING INFORMATION

Always follow the recommended wire strip lengths and wiring combinations when connecting wires. Hold stripped ends next to each other and align frayed strands (do not twist wires). Push wires firmly into wire nut. Using your fingers, twist wire nut clockwise until tight. Check for tightness by pulling wires.



## DIMMING

Dimming performance may not be the same or similar to dimming of incandescent bulbs. Some possible dimming variations include but are not limited to: less dimming range than an incandescent bulb; dimming less smooth than an incandescent bulb; flicker or shimmer at certain light levels; and, buzzing or humming at certain light levels. Bright33® warrants the compatibility of this dimmer with LED lighting products dimmable bulbs, and replacement of the dimmer is the sole remedy for incompatibility. Bright33® does not warrant the compatibility of this dimmer with any other particular LED lighting fixture. If you experience buzzing or flickering when using the dimmer, move the dimmer control to full and readjust the dimming setting to another setting.

## LIMITED WARRANTY

**LIMITED WARRANTY:** Bright33® warrants its Dimmers to be free from defect in material and workmanship for a period of one (1) year from the date of purchase. This warranty covers defects in manufacturing discovered while using the product as recommended by the manufacturer and does not apply to failures caused by acts of God or as a result of any abuse, misuse, abnormal use, or use in violation of any applicable standard, code, or instructions for use in installations.

If a Dimmer fails due to a defect covered by this warranty, Stream33 Products LLC will replace the product. To make a warranty claim, retain the failed products and send with proof of purchase, your name and address to the following address within thirty (30) days of the failure.

Stream33 Products LLC  
350 Courtney Road, Sebring, Ohio 44672 USA

## INSTALLING DIMMERS

### 1 TURN POWER OFF

Turn power off at circuit breaker or remove fuse.

**WARNING: SHOCK HAZARD. MAY RESULT IN SERIOUS INJURY OR DEATH. TURN OFF POWER AT CIRCUIT BREAKER BEFORE INSTALLING DIMMER.**



### 2

### REMOVE EXISTING DIMMER SWITCH

Take off wall-plate and switch by removing mounting screws. Carefully pull out switch from wall (**do not remove wires**).

### 3

### IDENTIFY THE TYPE OF CIRCUIT

**Single Pole:** If switch is wired with insulated wires connected to two screws of the same color. Go to Step 4A.

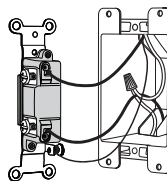

**3-Way:** If switch is wired with insulated wires connected to three screws and one of these wires is connected to a screw of a different color (not green) or labeled COMMON, mark or tag this wire to identify it when wiring. Go to Step 4B.

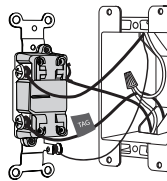

## 4A

### WIRE YOUR NEW DIMMER

#### Single Pole Circuit:

Connect the GREEN OR BARE dimmer ground wire to the green or bare copper ground wire in the wall-box.

Connect the BLACK dimmer wire to the hot input wire removed from the switch.

Connect one of the RED dimmer wires to the light fixture wire (load) removed from the switch.

Use remaining wire nut to cap the remaining RED wire on dimmer.

